

# Playground

Y M C A

25 CAP Center  
26 Calvert Gr. K/1

PE Shed

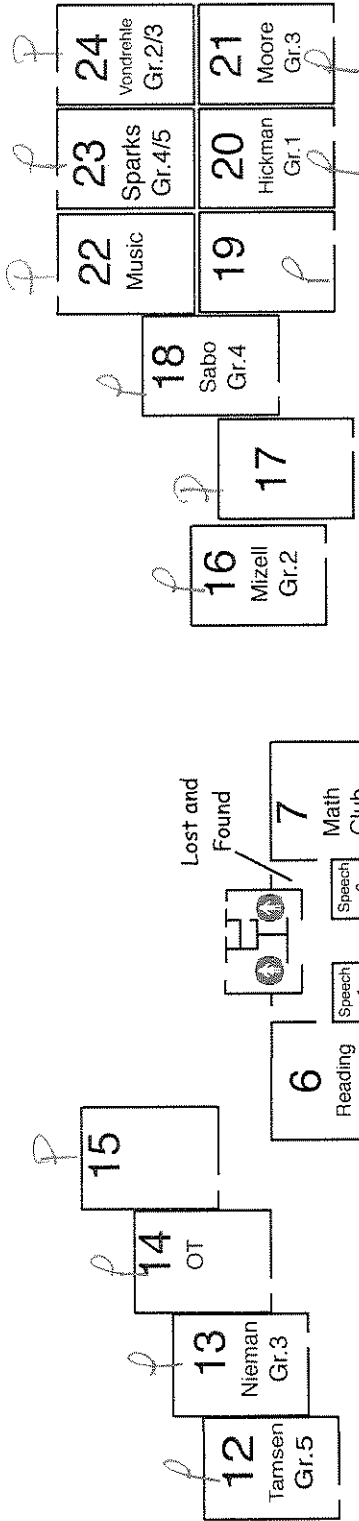

Shed

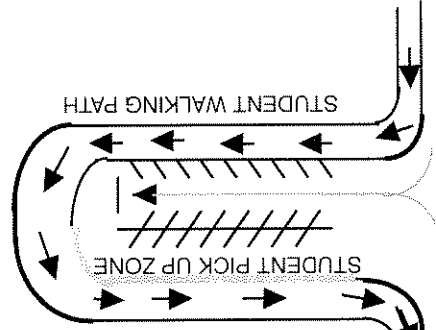

Blue Hills School  
Classroom Plan  
2016-2017

De Sanka Ave.

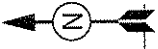

**L. P. COLLINS ELEMENTARY SCHOOL**  
 10300 North Blaney Avenue  
 Cupertino, CA 95014

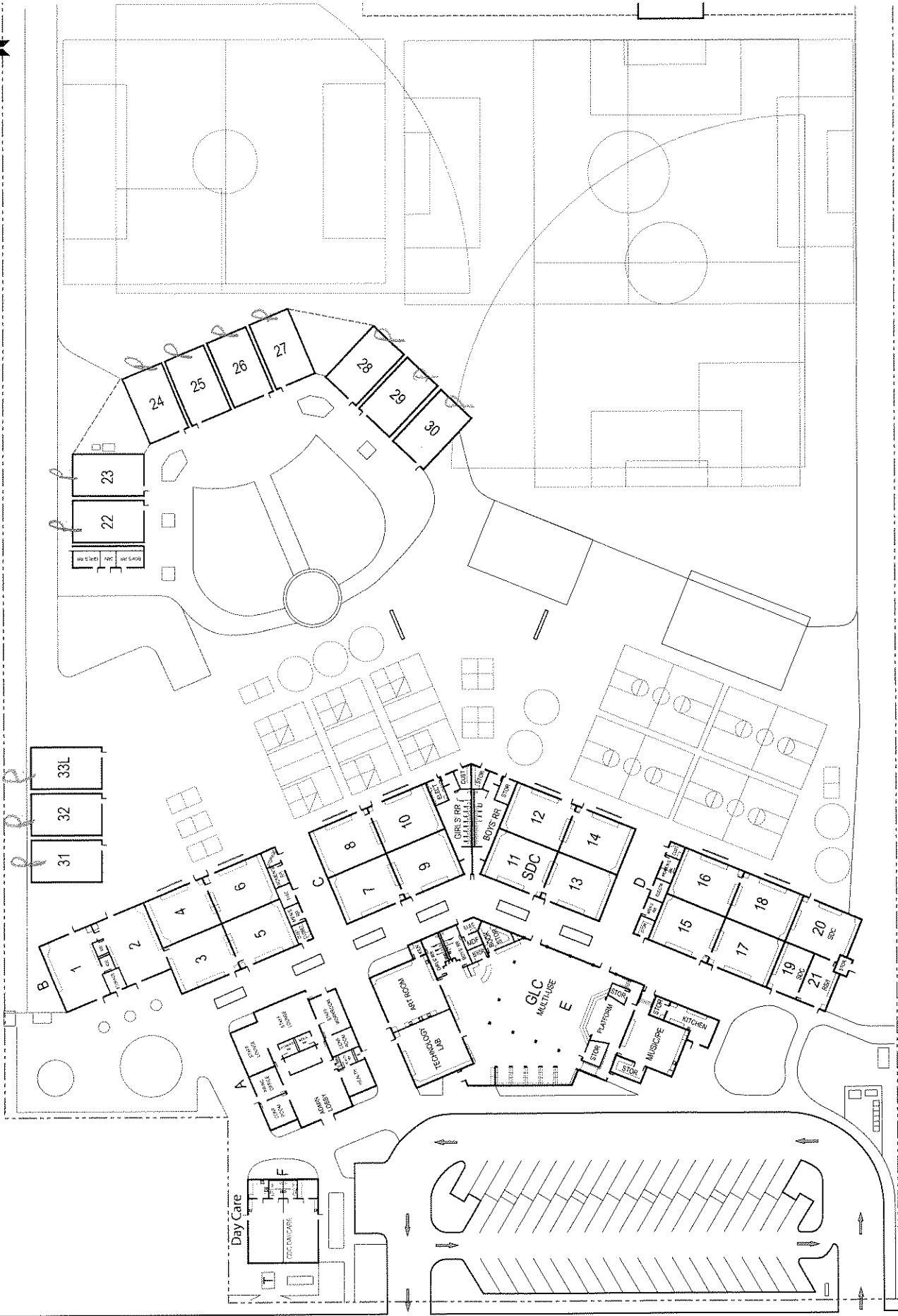

BLANEY AVENUE

Property, MV, 10/3/2013

FN: District Items/Facilities Information/CLUSD Sites In Adobe Illustrator/Collins@Portal

Scale = 1 cm:28 ft

Collins@Portal

we are going

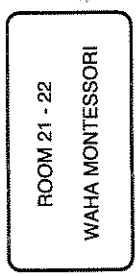
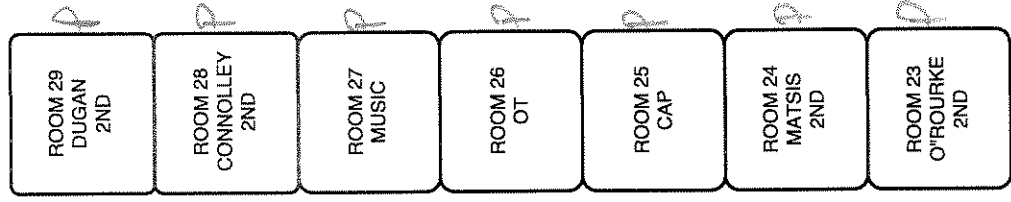
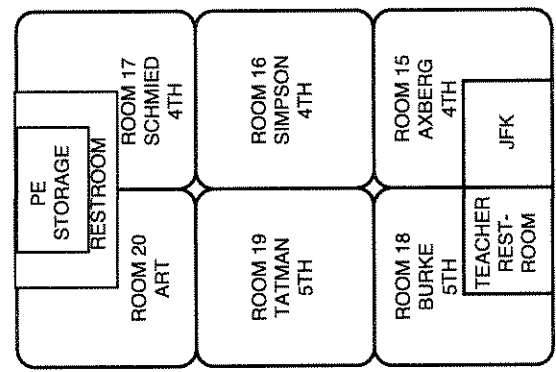
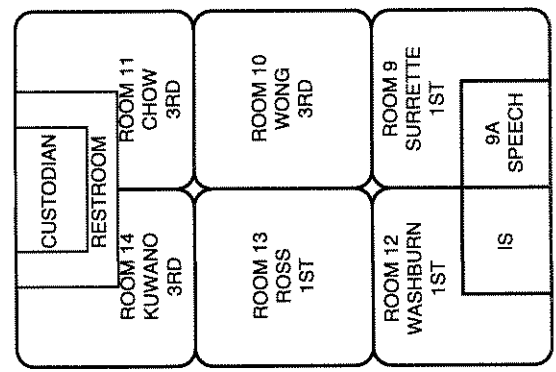
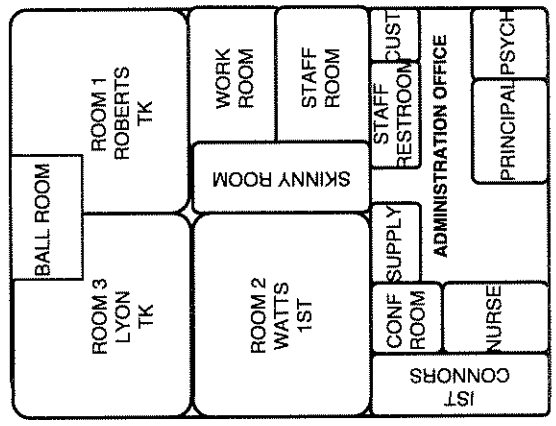
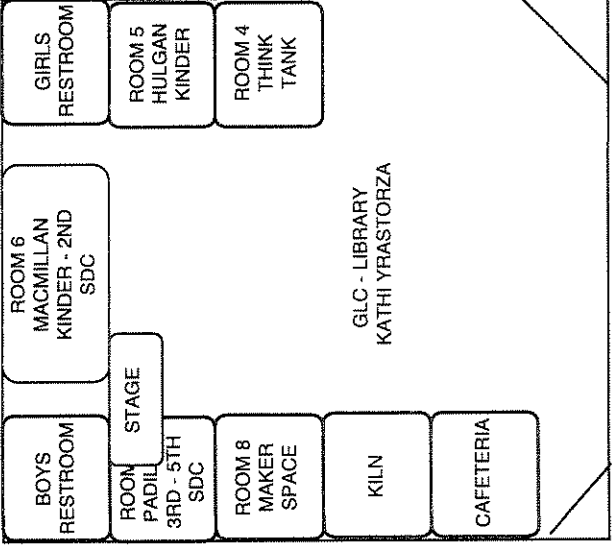
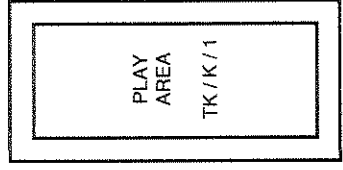
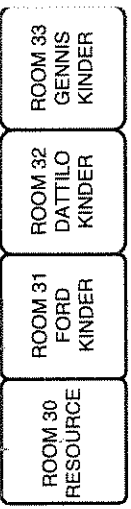

48,085 sq ft \* 11 acres \* 9/01/62  
 (Leased: 960x7 = 3,840 sq ft)

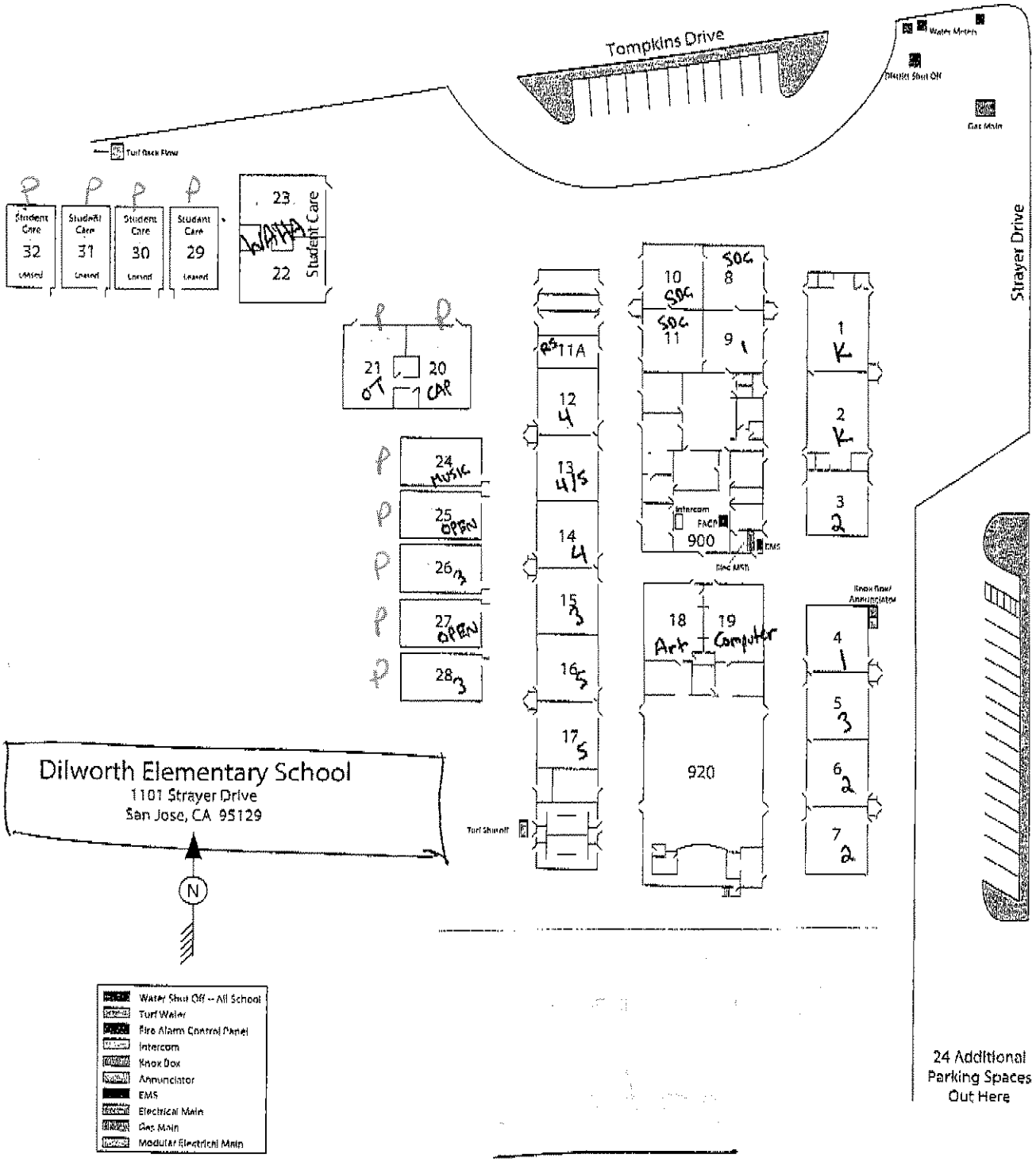

# Eaton School

2016-2017

Rm 1 Morgan Kinder/1	Rm 2 Van Dick Kinder
----------------------------	----------------------------

Rm 25 Webber 3rd
Rm 24 Resource
Rm 23 Tech Rm
Rm 22 Music

Rm 30 Hilden 3rd	
Rm 29 Mrakava 3rd	
Rm 28 OT/JFK	
Rm 27 Youngberg 3rd	
Rm 26 Parent Room	
Girls Rm.	Boys Rm.

Rm 3 Grafton
Rm 5 Bahar 2nd
Staff Rm
Workroom
Rm 7 Yasukawa 2nd
Rm 9 Merrick/Tam be 2nd

Rm 4 Schrader Kinder
Rm 6 Boote - SDC
Boy's Room
Girl's Room
Rm 8 Anderson 1st
Rm 10 Byers 1st

LUNCH
TABLES

Main  
Office

GLC (Library) and  
Tech Lab

Multi Purpose Room

L  
U  
N  
C  
H  
Room

Art  
Room

Rm 11 Tech
Rm 13 Kraft SDC
Room A - Yip/Hsu - 4th
Room B - Speech Joanne Room C - Psychologist
Rm 17 Biocini 5th
Rm 19 Opyd 5th

Rm 12 Larson 5th
Rm 14 Grant/Kraemer 2nd
Boy's Room
Girl's Room
Rm 16 Yip - 5th
Rm 18 Randhawa 4th

CDC  
20/21

8/11/2016

# EISENHOWER SCHOOL EVACUATION MAP 2016-2017

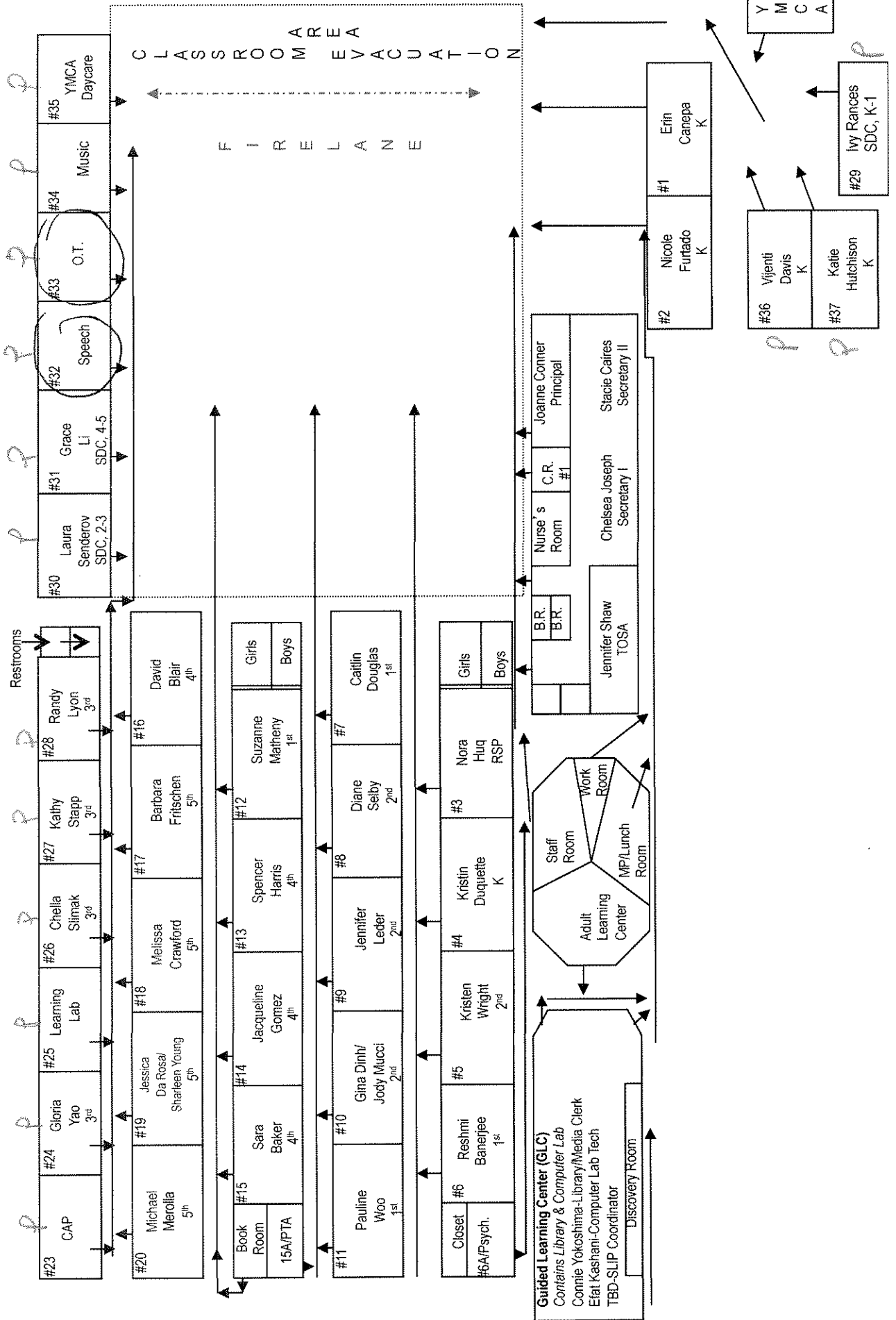

# Garden Gate Elementary School

10500 Ann Arbor Avenue  
Cupertino, CA 95014

54,483 sq ft \* 10 acres \* 6/30/65  
(4,320 sq ft Leased)  
(1-12x40, 1-24x40, 2-36x40)

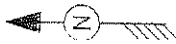

- RM. 1 CLAYTON - K
- RM. 2 A. WOLFF - K
- RM. 3 PICONE - 2nd
- RM. 4 GEBHART/ SZETO - 1<sup>st</sup>/2nd
- RM. 5 FOREMAN - 2nd
- RM. 6 BARR - 2nd
- RM. 6A BOOK RM.
- RM. 7 TUCKER - 3rd
- RM. 8 CHE - 4th
- RM. 9 HIGGINS - 4<sup>th</sup>
- RM. 10 PERRY-BARNEY - 4<sup>th</sup>/5th
- RM. 11 WARD - 3rd
- RM. 12 PTA
- RM. 13 DANGE - 5th
- RM. 14 P. CASEY - 5th
- RM. 15 LAWSON - 5th
- RM. 15A PORTER - Speech
- RM. 15B JFK COUNSELOR
- RM. 16A AFTER SCHOOL ENRICHMENT
- RM. 16B RESOURCE
- RM. 17 ORNELAS - 1st
- RM. 18 HERNANDEZ - 2nd
- RM. 19 LIBBY - PRESCHOOL
- RM. 20 DAYCARE - CDC
- RM. 21 DAYCARE - CDC
- RM. 22 CHENG - 1st
- RM. 23 JARRAR - 4th
- RM. 24 UNOCCUPIED
- RM. 25 PEARSON - 3rd
- RM. 26 NUCCI - 3rd
- RM. 27 AMARNATH - 3rd
- RM. 28 SMITH - 1st
- RM. 29 WESTGATE - 1st
- RM. 30 UNOCCUPIED
- RM. 31 PHYS ED
- RM. 32 LANZA - K
- RM. 33 R.WOLFF

2016 - 2017

## GRADES K-5 - DAILY SCHEDULE

KINDERGARTEN	8:00-2:05
PRIMARY (1-3)	8:00-2:05
UPPER (4-5)	8:00-2:30

## GRADES K-5 TUESDAY DISMISSAL - 1:30

MORNING RECESS	10:00-10:20
LUNCH GR. K-3	11:35-12:20
LUNCH GR. 4-5	11:50-12:35

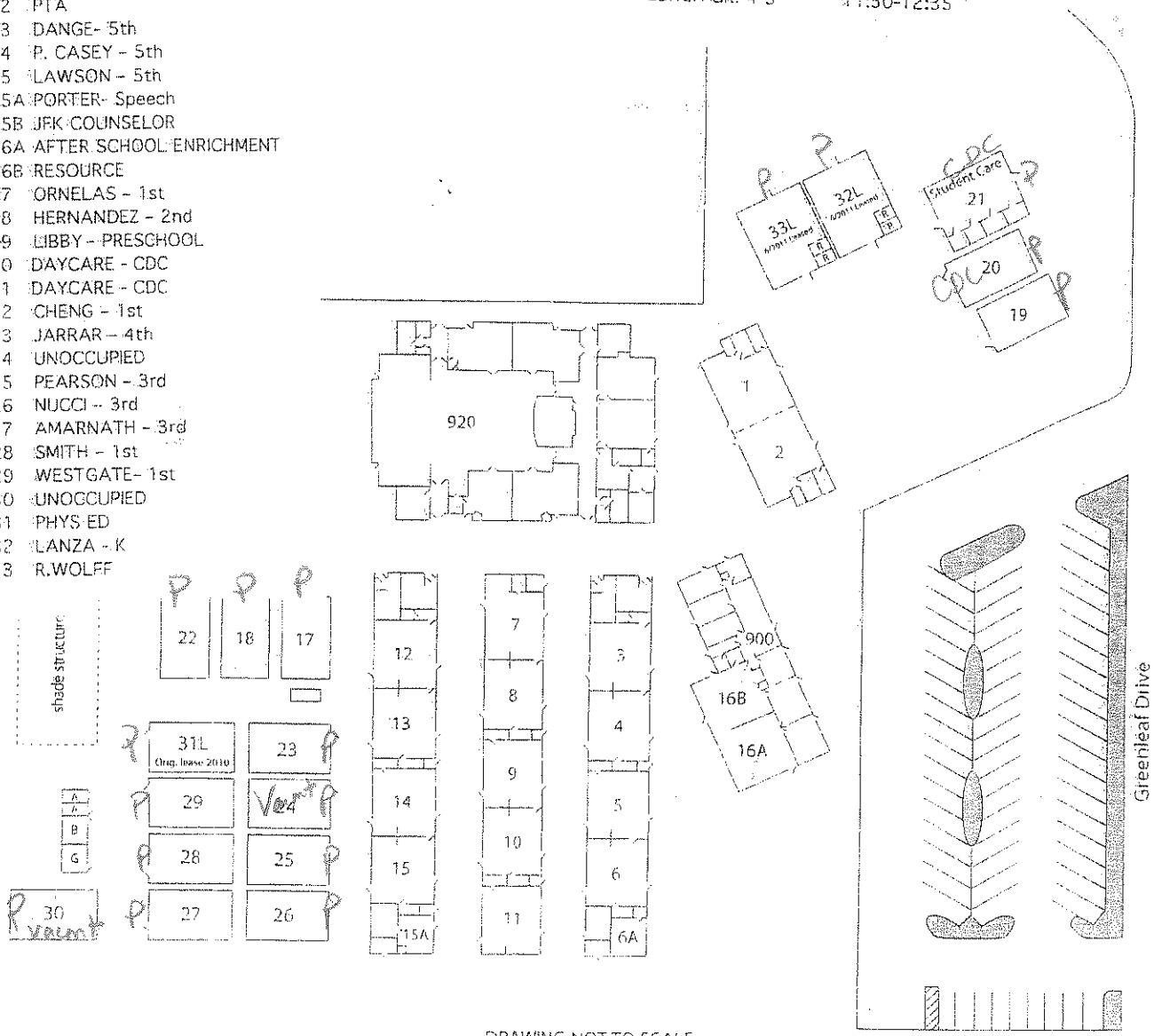

Rev. 6/14/2011

DRAWING NOT TO SCALE

Garden Gate

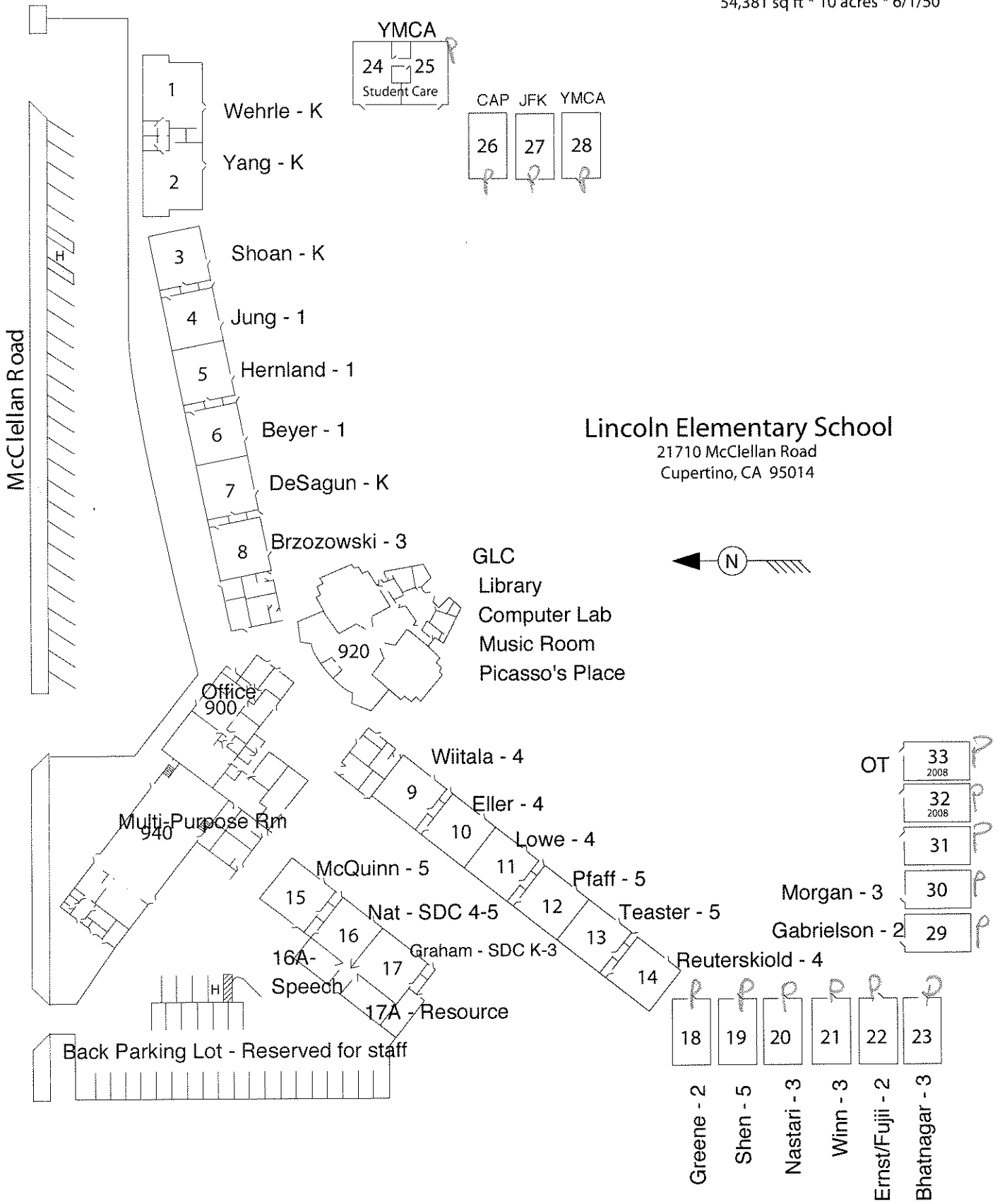



Meyerholz Elementary School

36	5 <sup>th</sup> S. Exousheon	37	4 <sup>th</sup> CLIP J. Sung
35	5 <sup>th</sup> V. Wheat	28	4 <sup>th</sup> CLIP J. Swainart
34	5 <sup>th</sup> CLIP Shuler	29	4 <sup>th</sup> J. Mazzon
33	5 <sup>th</sup> CLIP Y. Pao	30	4 <sup>th</sup> /5 <sup>th</sup> L. Dabel
32	RS Psych CAP	31	SDC 3-5 Tongate
31	Psych CAP	32	Psych CAP
30	4 <sup>th</sup> /5 <sup>th</sup> L. Dabel	33	5 <sup>th</sup> CLIP Y. Pao
29	4 <sup>th</sup> J. Mazzon	34	5 <sup>th</sup> CLIP Shuler
28	4 <sup>th</sup> CLIP J. Swainart	35	5 <sup>th</sup> V. Wheat
27	4 <sup>th</sup> CLIP J. Sung	36	5 <sup>th</sup> S. Exousheon

15	3 <sup>rd</sup> Nbb S. Lang	16	2 <sup>nd</sup> CLIP J. Lee	17	2 <sup>nd</sup> CLIP C. Huang	18	2 <sup>nd</sup> CLIP LL. Chern
14	2 <sup>nd</sup> R. Khare	13	3 <sup>rd</sup> J. Rose	12	3 <sup>rd</sup> K. Daxler	11	2 <sup>nd</sup> F. Yang

7	1 <sup>st</sup> Dong	8	1 <sup>st</sup> CLIP A. Tsai	9	1 <sup>st</sup> J. Wong	10	2 <sup>nd</sup> /3 <sup>rd</sup> K. Beals
6	SDC K-2 J. Lee	5	K CLIP C. Chan	4	1 <sup>st</sup> CLIP L. Liang	3	1 <sup>st</sup> CLIP J. Chen

K2	K C. Beals	K1	K J. Riano
----	---------------	----	---------------

26	3 <sup>rd</sup> CLIP K. Huang	25	3 <sup>rd</sup> CLIP L. Chiang	24	3 <sup>rd</sup> CLIP Yu
----	----------------------------------	----	-----------------------------------	----	----------------------------

19	Music	20	Art
----	-------	----	-----

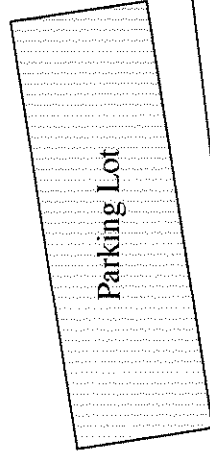
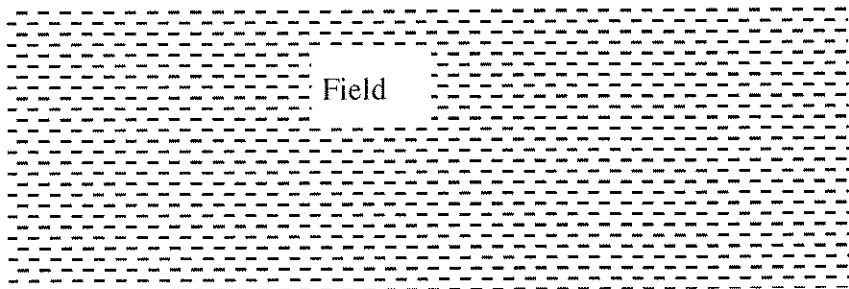
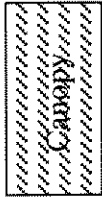
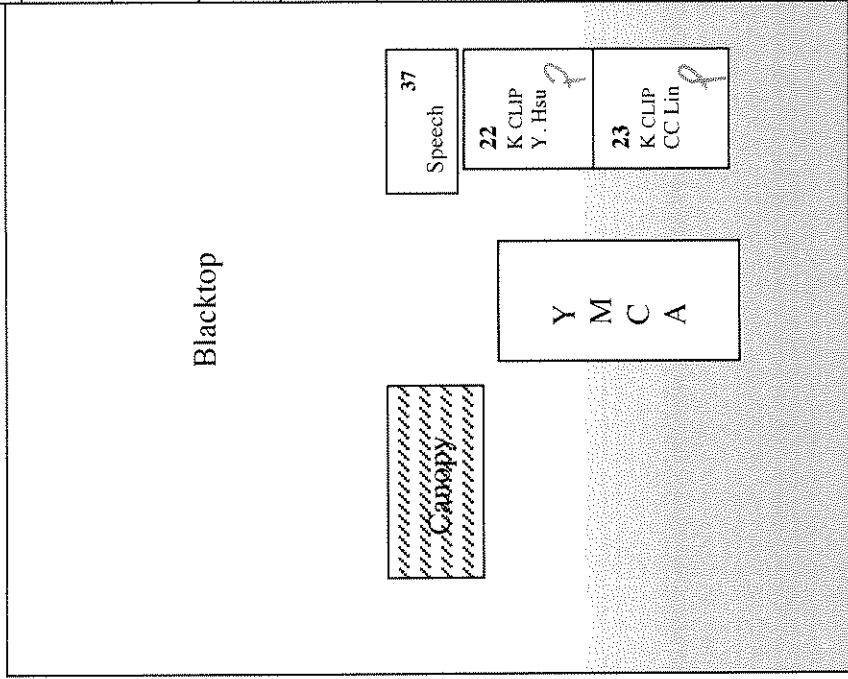
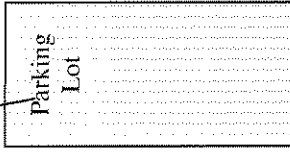
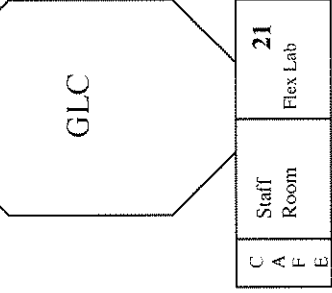

Melvin Drive

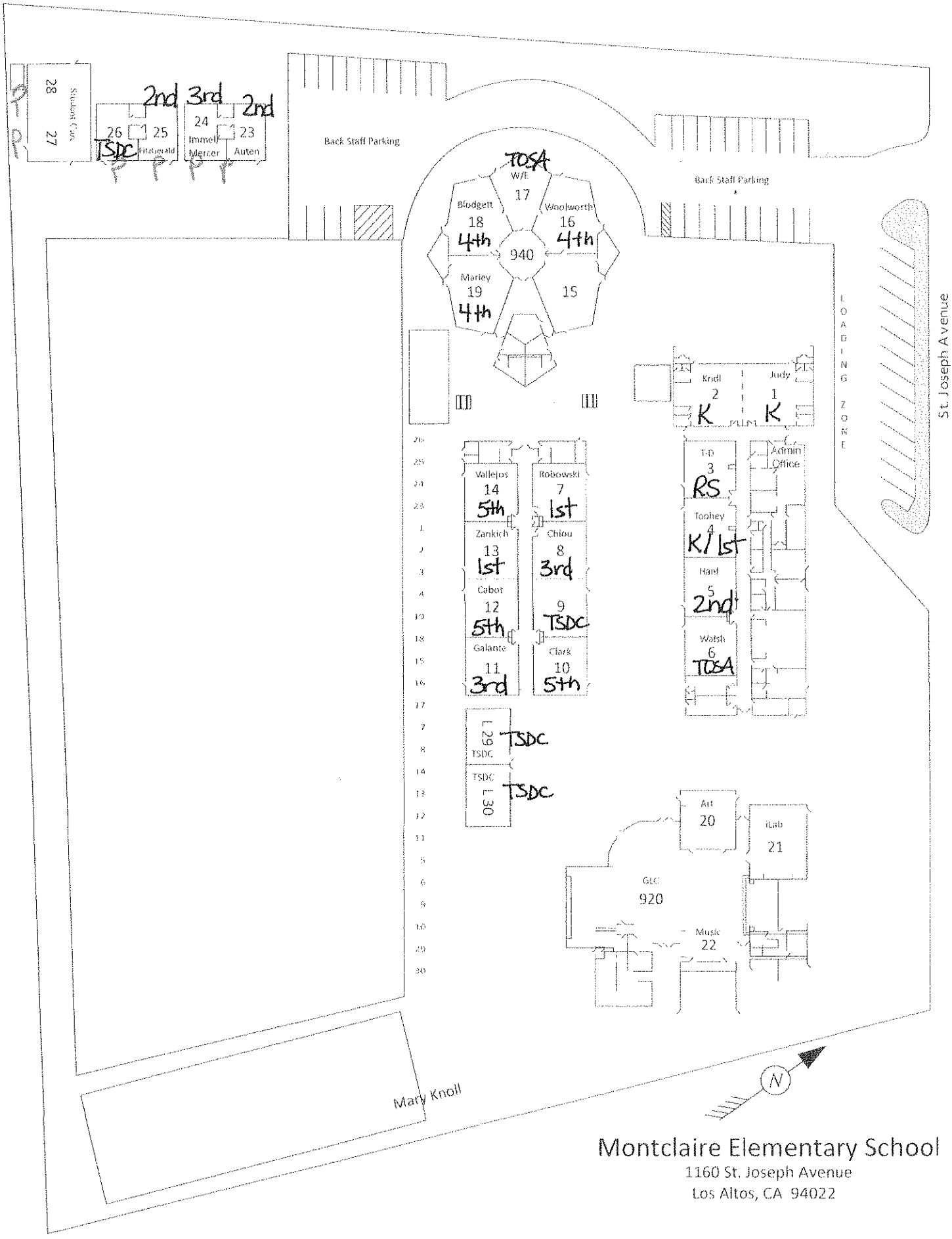

Montclair Elementary School  
 1160 St. Joseph Avenue  
 Los Altos, CA 94022

54,276 sq ft \* 10 acres \* 12/1/59  
(1,920 sq ft Leased)

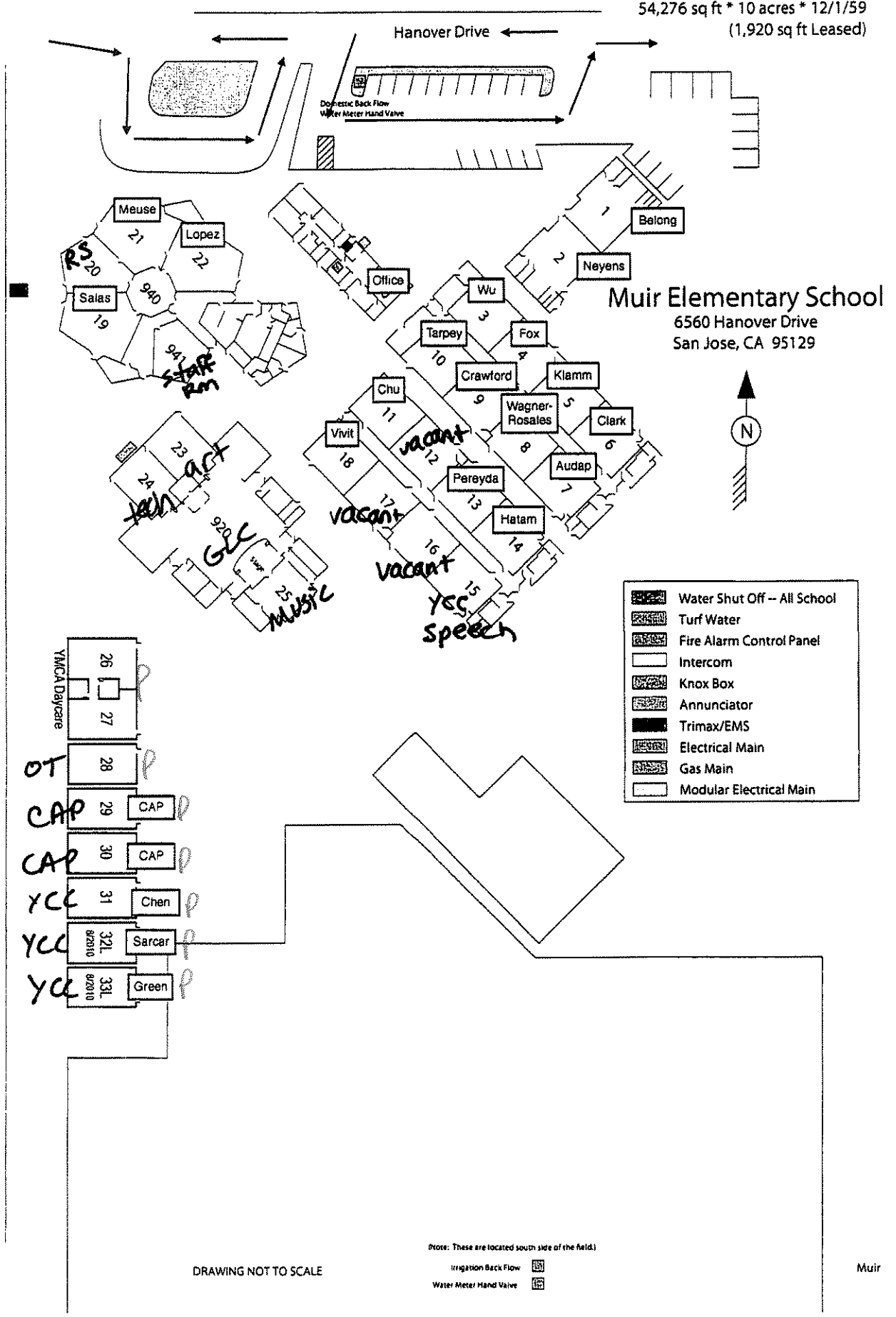

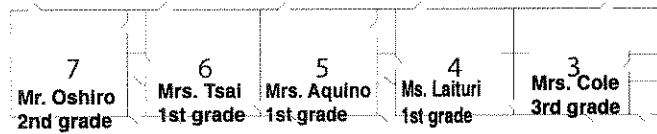
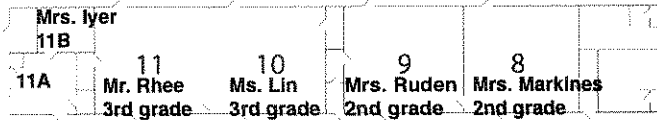
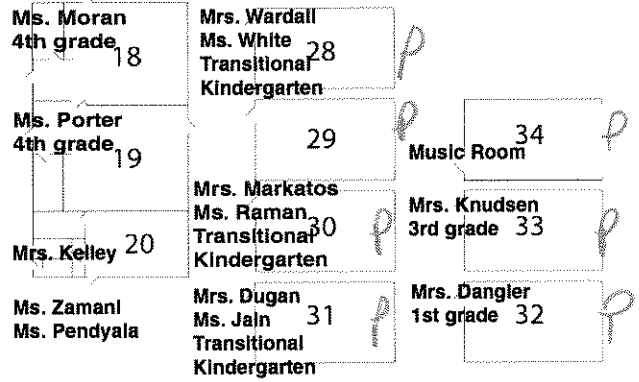
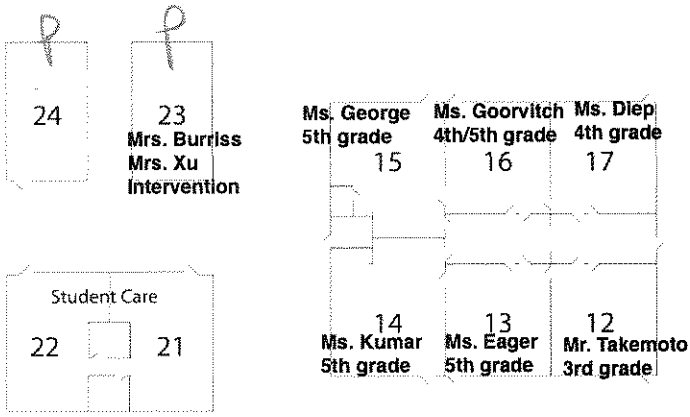

# Nimitz Elementary School

545 East Cheyenne Drive  
Sunnyvale, CA 94087

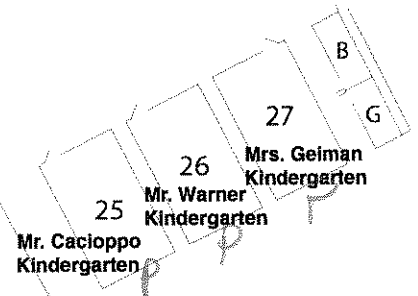
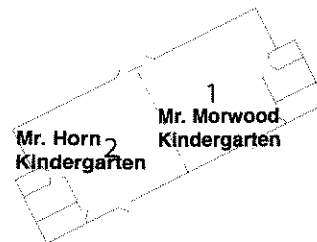
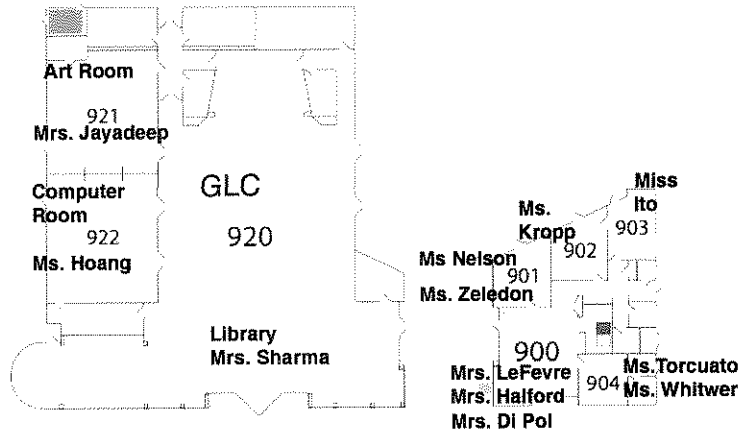
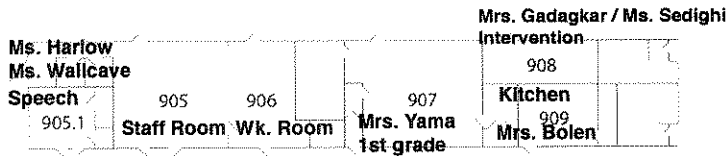

DRAWING NOT TO SCALE

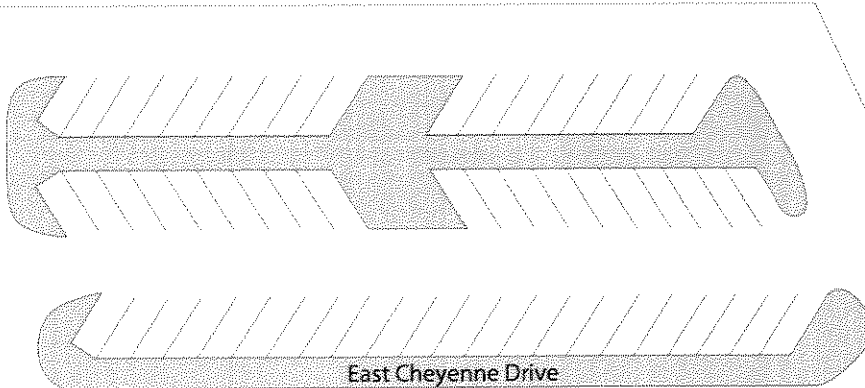

Yorkshire Drive

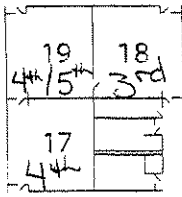
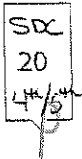
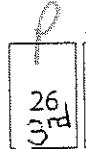

# Regnart Elementary School

1170 Yorkshire Drive  
Cupertino, CA 95014



54,884 sq ft \* 10 acres \* 12/1/59

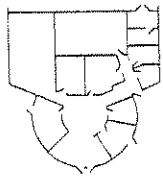
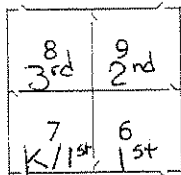
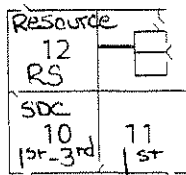
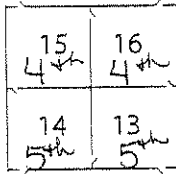

ADMIN. OFFICE

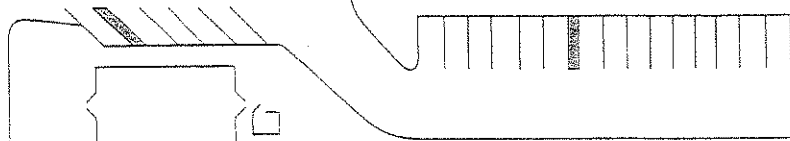
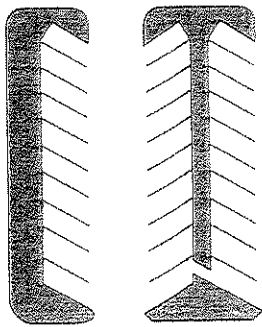
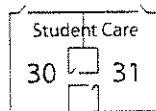
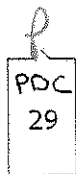
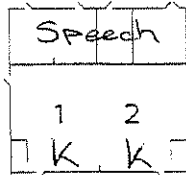
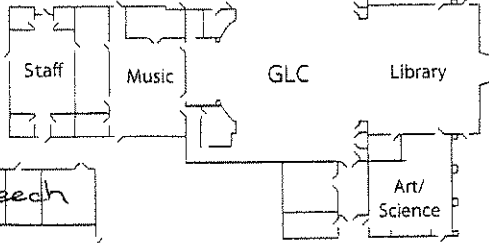
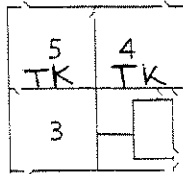

2016-17 Sedgwick Map

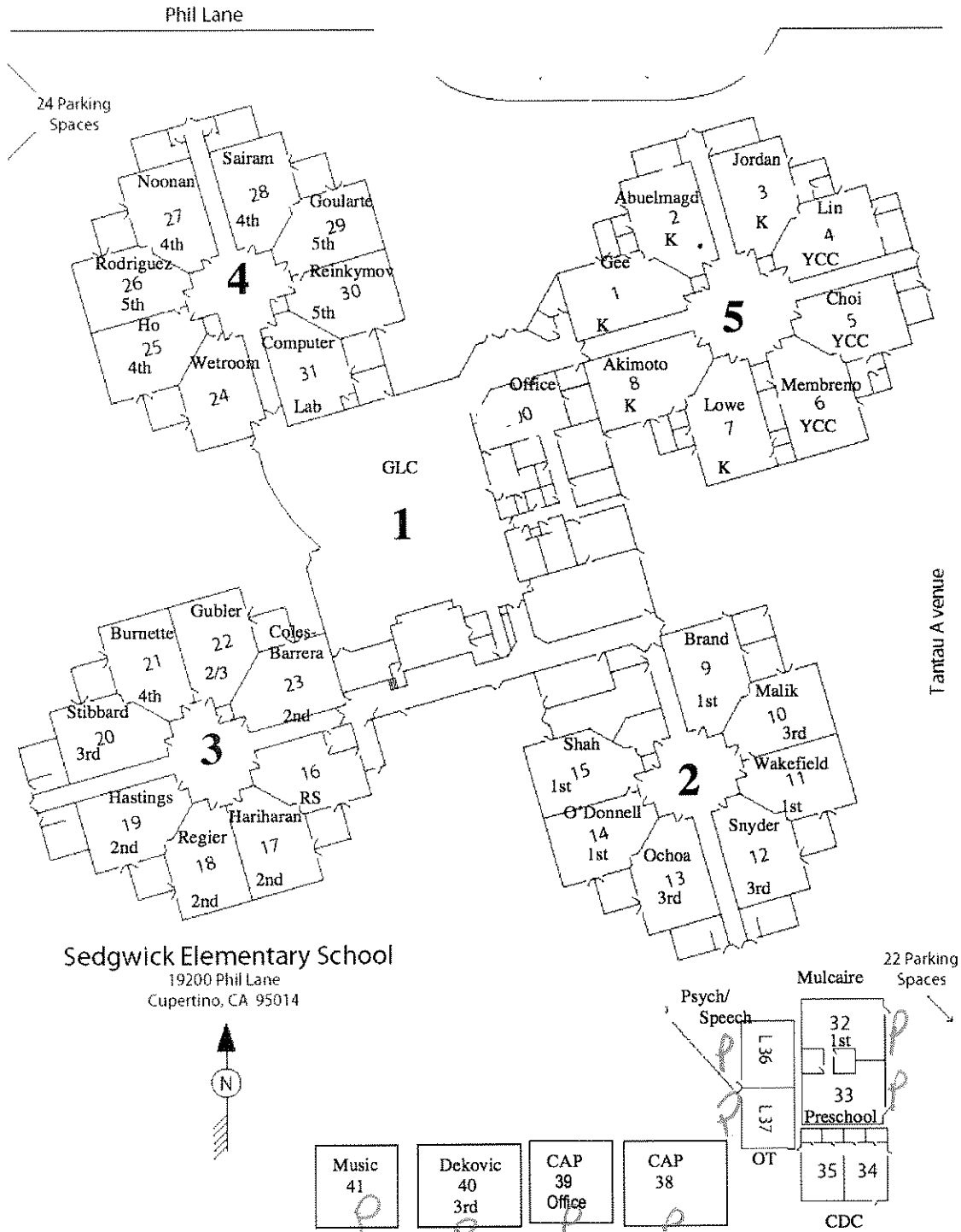

# Stevens Creek Elementary School

10300 Ainsworth Drive  
Cupertino, CA 95014

52,154 sq ft \* 10 acres \* 3/1/60  
(960 sq ft Leased)

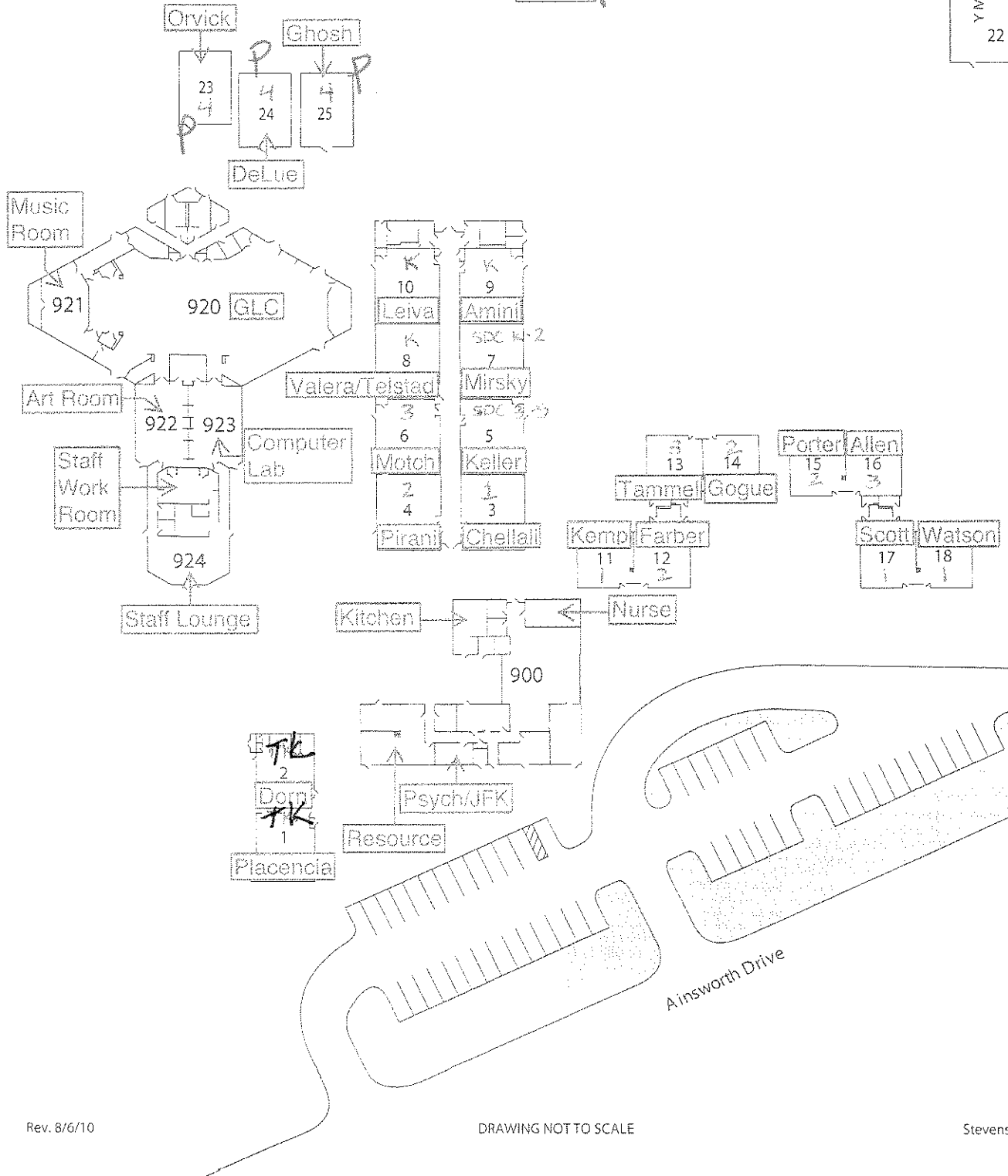
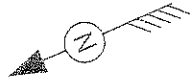

# Evacuation and Disaster Plan

Stockmeir Elementary School  
592 Dunholme Way, Sunnyvale, CA 94087

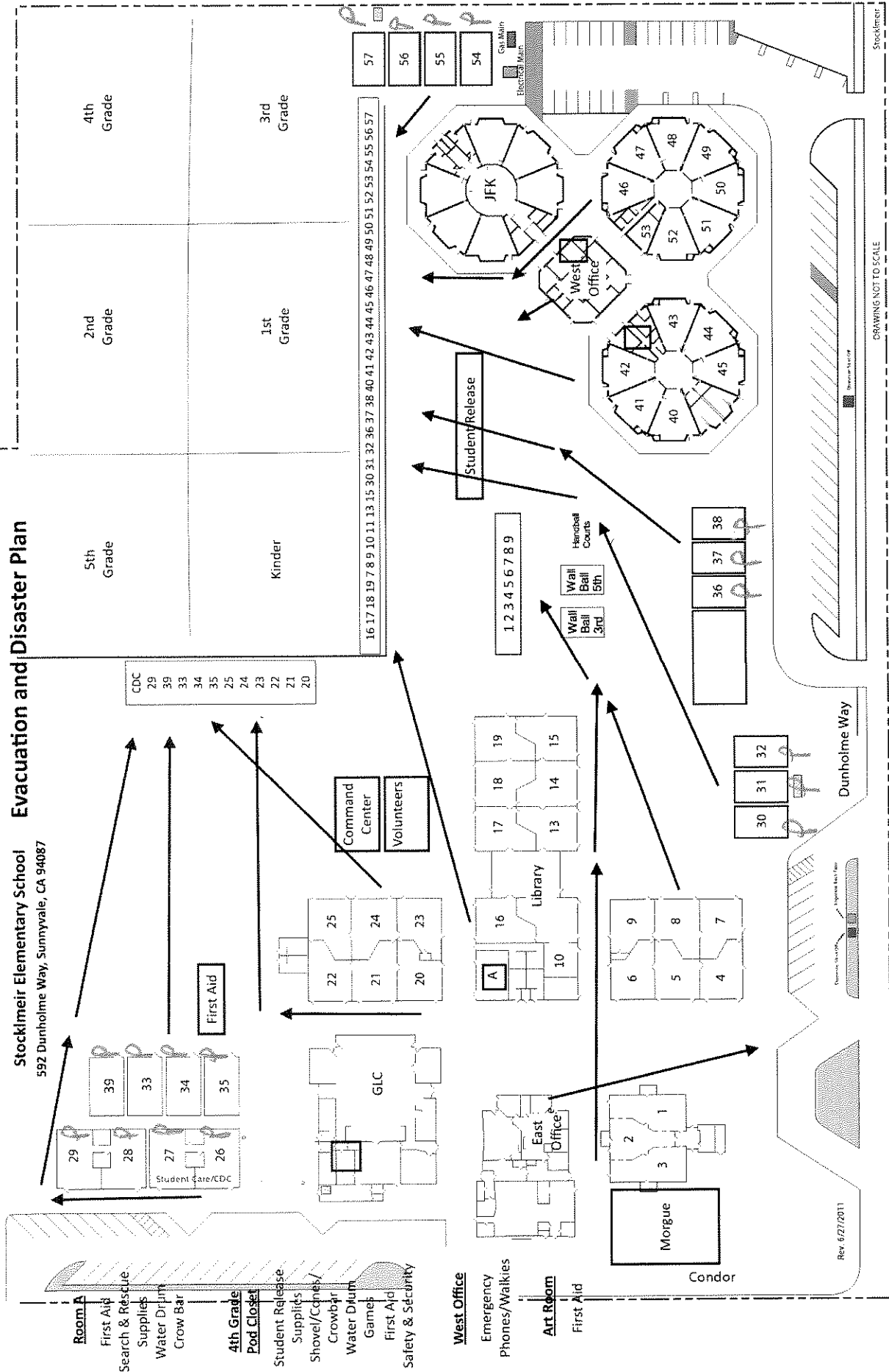

Rev 6/27/2011

DRAWING NOT TO SCALE



